

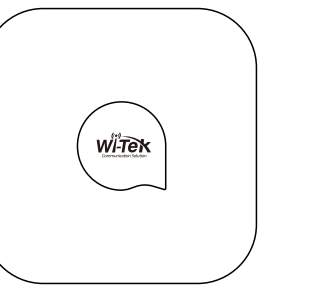

Quick Installation Guide

Cloud-Managed Wireless Ceiling Access Point



WI-AP210

www.wireless-tek.com

1. Packing Content



1 x AP



4 x Plastic Anchor 4 x Self-Tapping Screws



1 x Ethernet Cable

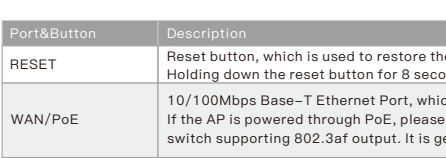

1 x Quick Installation Guide

2. Appearance Overview

• WI-AP210



• LED indicator

LED Indicators	Status	Description
System Indicator	Blue light	The system is starting.
	Green light	The system is restoring factory.
LAN Indicator	Yellow	The LAN port is connected via Ethernet cable
	Off	The LAN port is disconnected.

• Port and Button

Port&Button	Description
RESET	Reset button, which is used to restore the factory. Holding down the reset button for 8 seconds to revert to factory settings.
WAN/PoE	10/100Mbps Base-T Ethernet Port, which supports 802.3af PoE input. If the AP is powered through PoE, please connect this port to the PoE switch supporting 802.3af output. It is generally connected to the upstream switch.
LAN	10/100Mbps Base-T Ethernet port. It is generally connected to wired LAN devices such as PC.
DC	DC input: 12V,1A. The AP is powered through 12V DC input.

3. Typical Connection

• Bypass mode topology

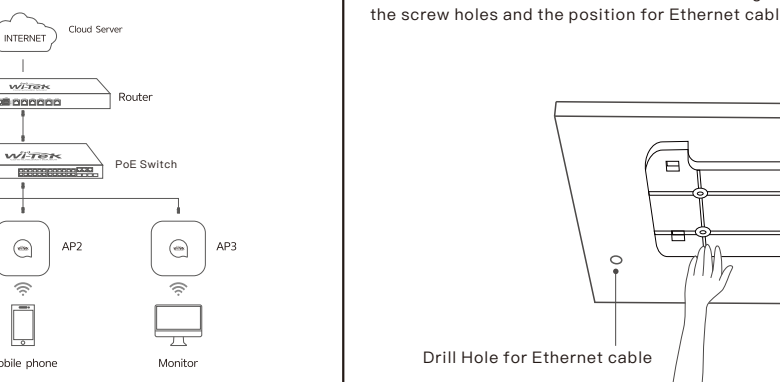

• AC Gateway mode topology

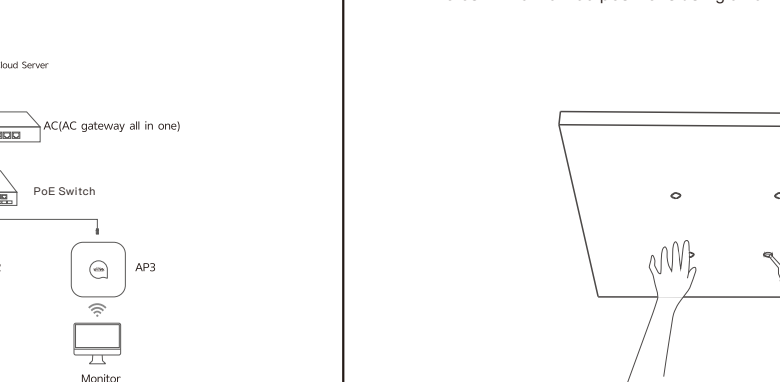

4. Device Installation

• Ceiling Mounting

- 1. Place the bracket in the center of the ceiling and then mark the positions for the screw holes and the position for Ethernet cable.

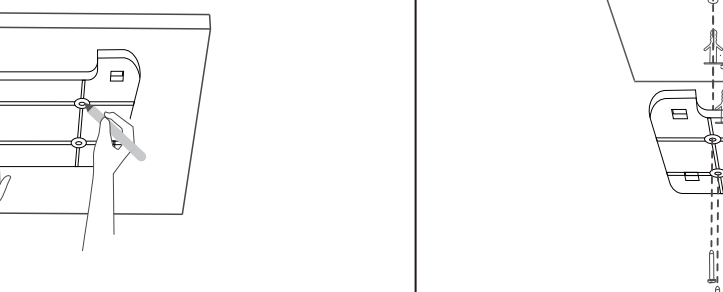

• 2. Drill holes in the marked positions using a hammer drill



5. Power Supply

• Power via PSE Device

- The APs can be powered via PoE switch which supports 802.3af PoE output.

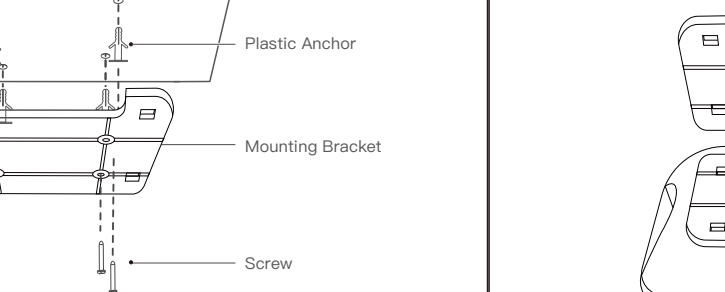

• Power via Power adapter

- Some APs can be powered via power adapter which supports 12V DC output.

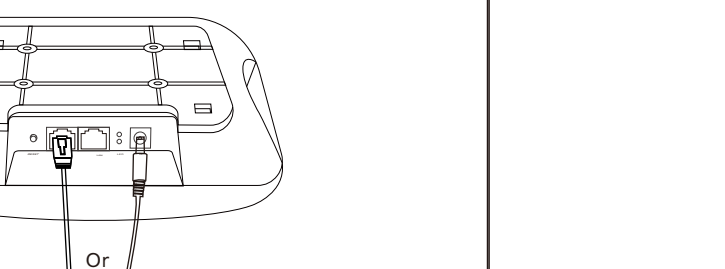

6. Configuration Method

Method 1.



Method 2.



Step 1. On the computer, please set the static IP under the same subnet with AP, 192.168.1.xx

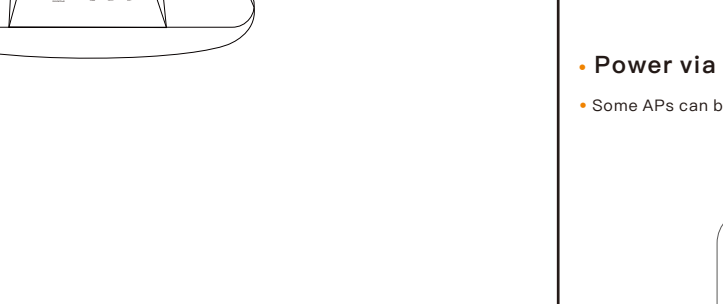

Step 2. Please launch a browser such as Google Chrome or Firefox, type 192.168.1.88 into address bar and click on enter to get in the login page of wireless access point. The default login password is "admin".

*Login device



Step3. After get in the management page, On the left side menu, please go to [Wizard] to setup the access point

7. Cloud management settings

Step 1

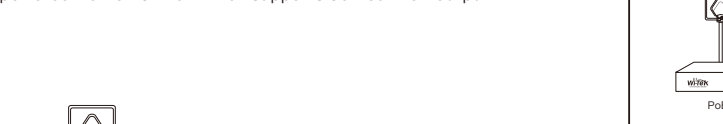

Step 2



Step 1 Launch your web browser then enter http://cloud2.wireless-tek.com in the address bar. Step 2 Register an account password by user name or email. Step 3 log in to the cloud account with the account password after registration.

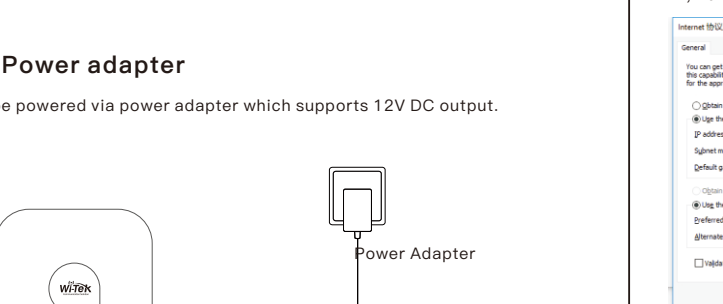

Step 1 Click ADD NETWORK

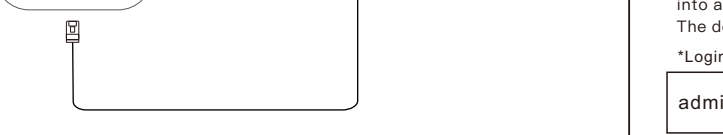

(2) Fill in the group name and location, click save.



8. FAQ

Q1. The LED is not lit.

- A1: Please check the PoE switch is 802.3af/at.
- A2: Make sure the PoE switch is outputting the correct voltage.
- A3: Make sure the Ethernet cable does support PoE function.

Q2. What can I do if the login window does not appear?

- A1: Please check if the computer is the static IP 192.168.1.xxx.
- A2: Please try another browser.
- A3: Reboot your AP device and try again.
- A4: Disconnect the Internet connection and try again, after login, connect to the internet.

9. Warranty Card

Username	
Address	
Telephone No.	
Purchase Shop	
Purchase Address	
Product Model No.	
Purchase Time	
Serial No.	
Dealer Signature	

8. FAQ

-If the product defects within three months after purchase, we will provide you a new product of the same model.
 -If the product defects within the three-year warranty period, we will provide the professional maintenance service.
 -Proof of purchase and a complete product serial number are required to receive any services guaranteed as part of the limited warranty.
 -Any other defects that are not caused by workmanship or product quality, such as natural disasters, water damage, extreme thermal or environmental conditions, sticker damaged, warranty card losing will disqualify the product from limited warranty.

Technical Support: [QR Code]
 Company Website: [QR Code]
 Cloud Management: [QR Code]

Wireless-Tek Technology Limited
 Address: Biao'an Technology Building 402, Bao'an street, Bao'an District, Shenzhen City, Guangdong, China
 Website: www.wireless-tek.com
 Tel: 86-0755-32811290
 Email: sales@wireless-tek.com
 Technical Support: tech@wireless-tek.com

CE FC RoHS UK CA